



The future is clean air ... the future is **Sourcetec**

www.sourcetecindustries.com E-mail: sales@sourcetecindustries.com

Tel: (905) 678-9333 1-800-784-2383 Fax: (905) 678-7133

TECHNICAL INFORMATION

This drawing is the sole property of Sourcetec Industries Inc. We reserve the right to change specifications and details without prior notice. Unauthorized duplication, distribution or use by a third party is strictly prohibited.

SERIES "MEHR" HEAVY DUTY MOTORIZED HOSE REEL

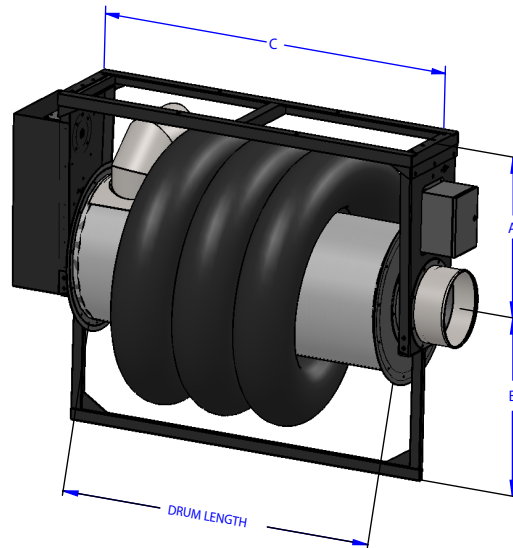

MODEL	DRUM ϕ In. (mm)	DRUM LENGTH In. (mm)	HOSE ϕ In. (mm)	HOSE UP TO Ft. (m)	A	B	C
MEHR-1020	24 (610)	30 (762)	10 (254)	20 (6.1)	27 (686)	30 (762)	37 (940)
MEHR-1030	24 (610)	40 (1016)	10 (254)	30 (9.1)	27 (686)	30 (762)	47 (1194)
MEHR-1040	24 (610)	50 (1270)	10 (254)	40 (12.2)	27 (686)	30 (762)	57 (1448)
MEHR-1050	24 (610)	60 (1524)	10 (254)	50 (15.2)	27 (686)	30 (762)	67 (1702)
MEHR-1220	24 (610)	35 (889)	12 (305)	20 (6.1)	29 (737)	32 (813)	42 (1067)
MEHR-1230	24 (610)	45 (1143)	12 (305)	30 (9.1)	29 (737)	32 (813)	52 (1321)
MEHR-1240	24 (610)	55 (1397)	12 (305)	40 (12.2)	29 (737)	32 (813)	62 (1575)
MEHR-1250	24 (610)	65 (1651)	12 (305)	50 (15.2)	29 (737)	32 (813)	72 (1829)

** Dimensions are for reference only

DESCRIPTION:

MEHR Motorized Hose Reels are equipped with either a 1/2HP or 3/4HP, 115/1/60 Motor, Control Panel and Gear Reducer and Reinforced Steel design. MEHR can be operated with wall UP/DOWN controls or hanging pendant switch. Available in hose sizes 10" Dia up to 14" Dia. Various hose temperatures are available.

APPLICATIONS:

- Transit Facilities
- Public Works Maintenance Garages
- Military Vehicle Maintenance Facilities

STANDARD FEATURES:

- Heavy Duty Steel Frame
- Control Panel
- Gear Reducer
- Heavy Duty Motor

OPTIONAL FEATURES:

- Other Voltages available
- Custom Adapters
- Hi- Temperature Hose
- Other colors and finishes available